

## Insulation

The following instructions are provided for the installation of PowerFoam rigid board insulation. PowerFoam rigid board insulation can be installed by a certified installer or a homeowner that has fully read and understands these instructions. The instructions herein provide general guidance only and do not cover all aspects related to the installation or use of insulation in a building.

Before starting, ensure that the installation complies with the applicable building code requirements. The building code may have requirements for thickness and R-value of the insulation, vapor retarders, interior thermal barriers and finish materials, exterior weather resistive barriers and claddings, ventilation, insulation in adjacent areas, caulking and sealing, and other items.

As the installer, you are solely responsible for the proper installation of all materials, following product label instructions and for using proper safety precautions during installation to avoid injury. PowerFoam is not responsible for building design and accepts no responsibility for the performance of its products resulting from improper building design, construction faults, or defective installation workmanship.

### Tools Needed

- Tape Measure
- Utility Knife
- Straightedge
- Cordless Drill
- Saw
- Hammer
- Nail Gun
- Caulk Gun

### Protective Gear

- Work Gloves
- Loose-fitting, long-sleeved shirt
- OSHA-approved safety glasses
- Disposable dust respirator (NIOSH or MSHA approved)
- No requirement for re-entry or re-occupancy times.

## APPLICATION OF POWERFOAM R-CONTROL INSULATION BOARDS TO A CONCRETE WALL:

1. Remove any obstacles or debris from the wall and area of work that may interfere with the attachment of the boards.
  2. Cut the boards to match the wall height.
    - Note: Cut the boards as needed to fit tightly around pipes, ducts, vents, openings or similar objects.
    - Note: PowerFoam R-Control insulation boards must not be installed in contact with hot objects (e.g. chimneys, furnace and water flues, lighting fixtures, etc.). Maintain gaps in accordance with the applicable building code.
  3. Install lumber blocking as required by the applicable building code requirements.
  4. Using foamboard compatible adhesive, apply the adhesive to the wall, or directly to the board, in vertical beads approximately 12" apart.
  5. Press/hold the board firmly to the wall.
  6. Position wood battens at 16" or 24" on center spacing (vertically or horizontally) over the boards and attach using PowerFoam R-Control concrete nails 24" on center through the battens and insulation into the concrete wall.
    - Note: PowerFoam R-Control Concrete Fasteners for concrete masonry units or solid concrete walls are available from PowerFoam.
    - Note: Wood battens must be pressure treated when used below grade or when in direct contact with concrete.
  7. Air seal all electrical, water, or gas penetration and any venting that pass to the outside with silicone caulk, acrylic latex caulk, or expanding spray foam.
  8. **Interior Application:**
    - a. Install vapor retarder, as required by the applicable building code requirements.
    - b. Install a code compliant thermal barrier, such as 1/2" gypsum board, to the battens.
- Exterior Application (above grade):**
- a. Install a code compliant weather resistive barrier.
  - b. Install a code compliant weather resistive exterior cladding.
- Exterior Application (below grade):**
- Waterproof or dampproof walls with foamboard compatible products prior to installation of PowerFoam R-Control insulation boards.

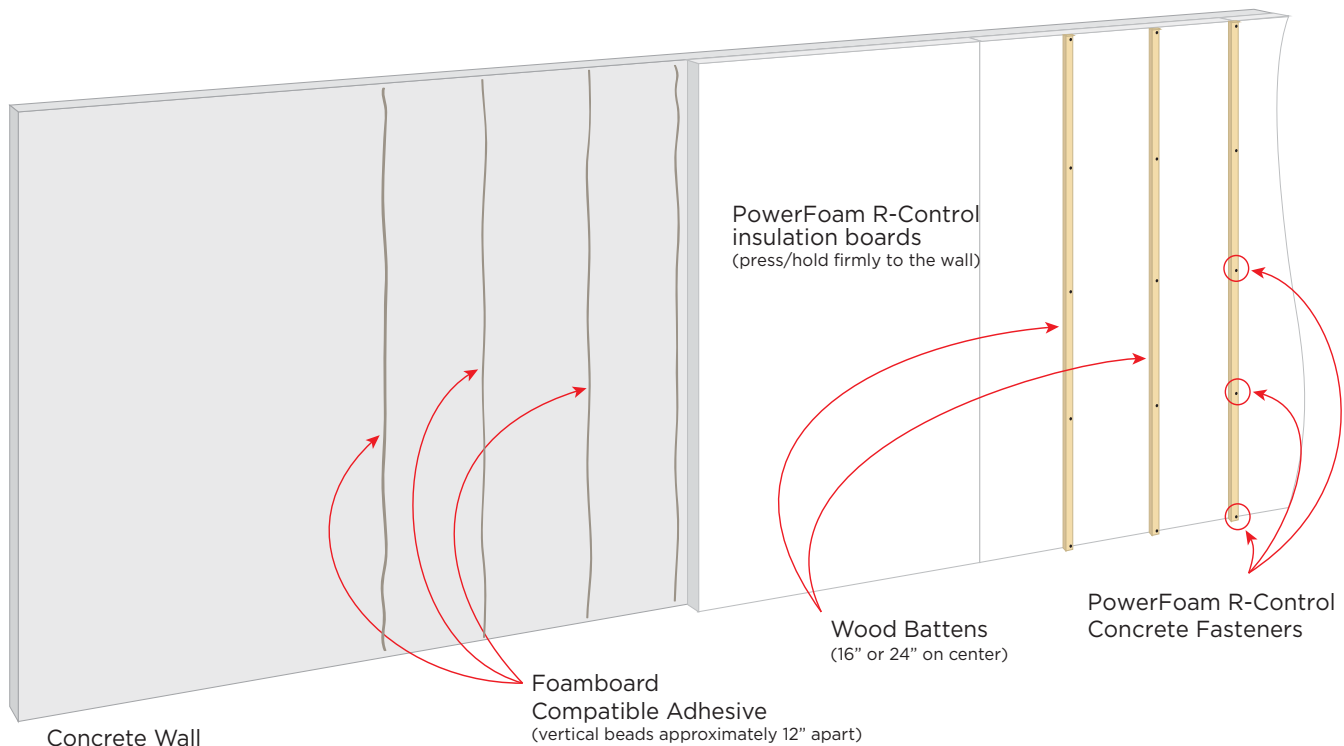

## APPLICATION OF POWERFOAM R-CONTROL INSULATION BOARDS TO A WOOD FRAMED WALL:

1. Remove any obstacles or debris from the wall and area of work that may interfere with the attachment of the boards.

Note: The wall to receive the board must be braced or sheathed in compliance with the applicable building code.

2. Cut the boards to match the wall height.

Note: Cut the boards as needed to fit tightly around pipes, ducts, vents, openings or similar objects.

3. Install lumber blocking as required by the applicable building code requirements.

4. Using foamboard compatible adhesive, apply adhesive to the wood studs.

5. Press/hold the board firmly to the wall.

Note: All vertical edges of the PowerFoam R-Control insulation must be supported by the wood studs.

6. Position wood battens aligned with the location of the underlying wood studs and attach using PowerFoam R-Control wood screws 24" on center through the battens and insulation into the wood studs.

Note: PowerFoam Wood Fasteners for wood framed walls are available from PowerFoam.

Note: PowerFoam R-Control insulation boards must not be installed in contact with hot objects (e.g. chimneys, furnace and water flues, lighting fixtures, etc.). Maintain gaps in accordance with the applicable building code.

7. Air seal all electrical, water, or gas penetration and any venting that pass to the outside with silicone caulk, acrylic latex caulk, or expanding spray foam.

8. **Interior Application:**

a. Install vapor retarder, as required by the applicable building code requirements.

b. Install a code compliant thermal barrier, such as 1/2" gypsum board, to the battens.

**Exterior Application (above grade):**

a. Install a code compliant weather resistive barrier.

b. Install a code compliant weather resistive exterior cladding.

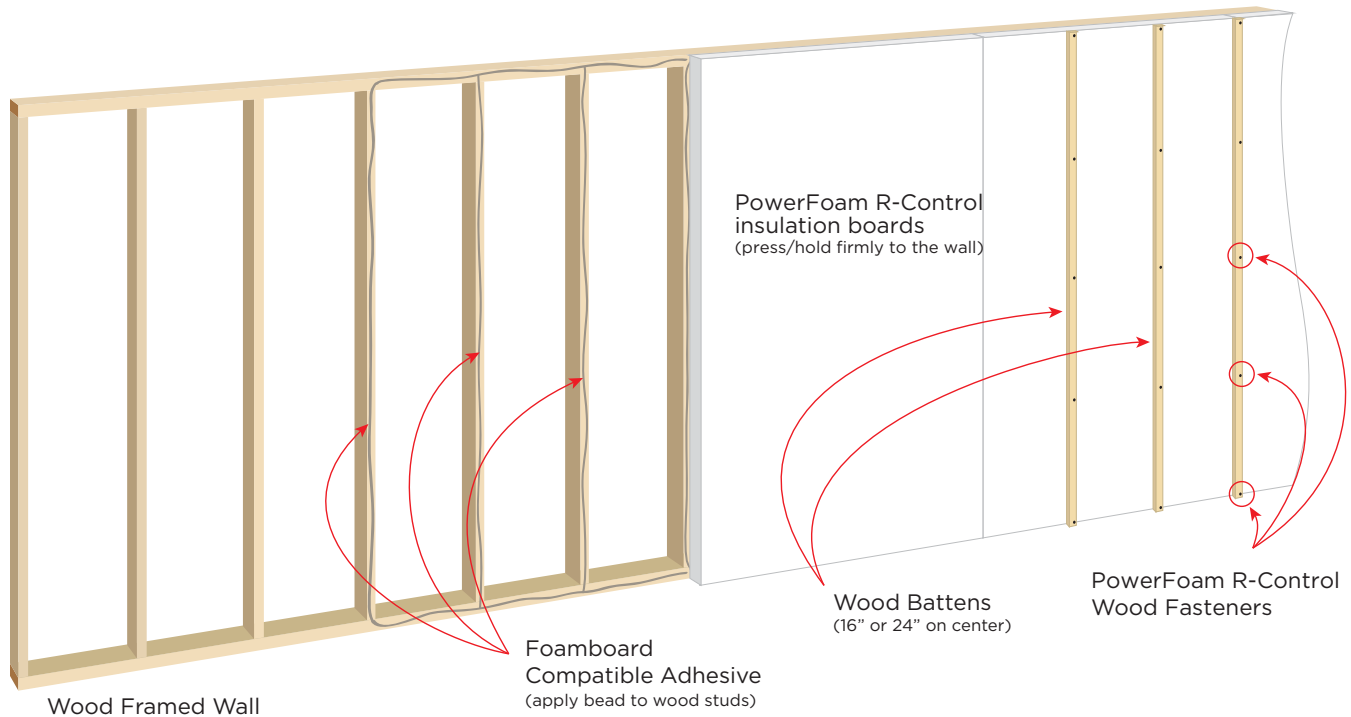

## APPLICATION OF POWERFOAM R-CONTROL INSULATION BOARDS TO INTERIOR OF A CONCRETE CRAWL SPACE WALL:

1. Remove any obstacles or debris from the wall and area of work that may interfere with the attachment of the boards.
2. Cut the boards to match the wall height.
  - Note: Cut the boards as needed to fit tightly around pipes, ducts, vents, openings or similar objects.
3. Using foamboard compatible adhesive, apply the adhesive to the wall, or directly to the board, in vertical beads approximately 12" apart.
4. Press/hold the board firmly to the wall.
5. Attach using PowerFoam R-Control concrete screws through the insulation into the concrete wall at the 4 corners and center of each board.
  - Note: PowerFoam Concrete screws for concrete masonry units or solid concrete walls are available from PowerFoam.
  - Note: PowerFoam insulation boards must not be installed in contact with hot objects (e.g. chimneys, furnace and water flues, lighting fixtures, etc.). Maintain gaps in accordance with the applicable building code.
6. Air seal all electrical, water, or gas penetration and any venting that pass to the outside with silicone caulk, acrylic latex caulk, or expanding spray foam.
7. Install vapor retarder, ignition barrier, or thermal barrier (gypsum board), as required by the applicable building code requirements.
  - Note: In an unvented crawl space, the edges of the vapor retarder covering the floor space shall extend at least 6 inches (152 mm) up the stem wall and shall be attached and sealed to the PowerFoam R-Control insulation.
  - Note: In areas of "very heavy" termite infestation, the clearance between PowerFoam insulation boards installed above grade and exposed earth shall be at least 6 inches (152 mm) .

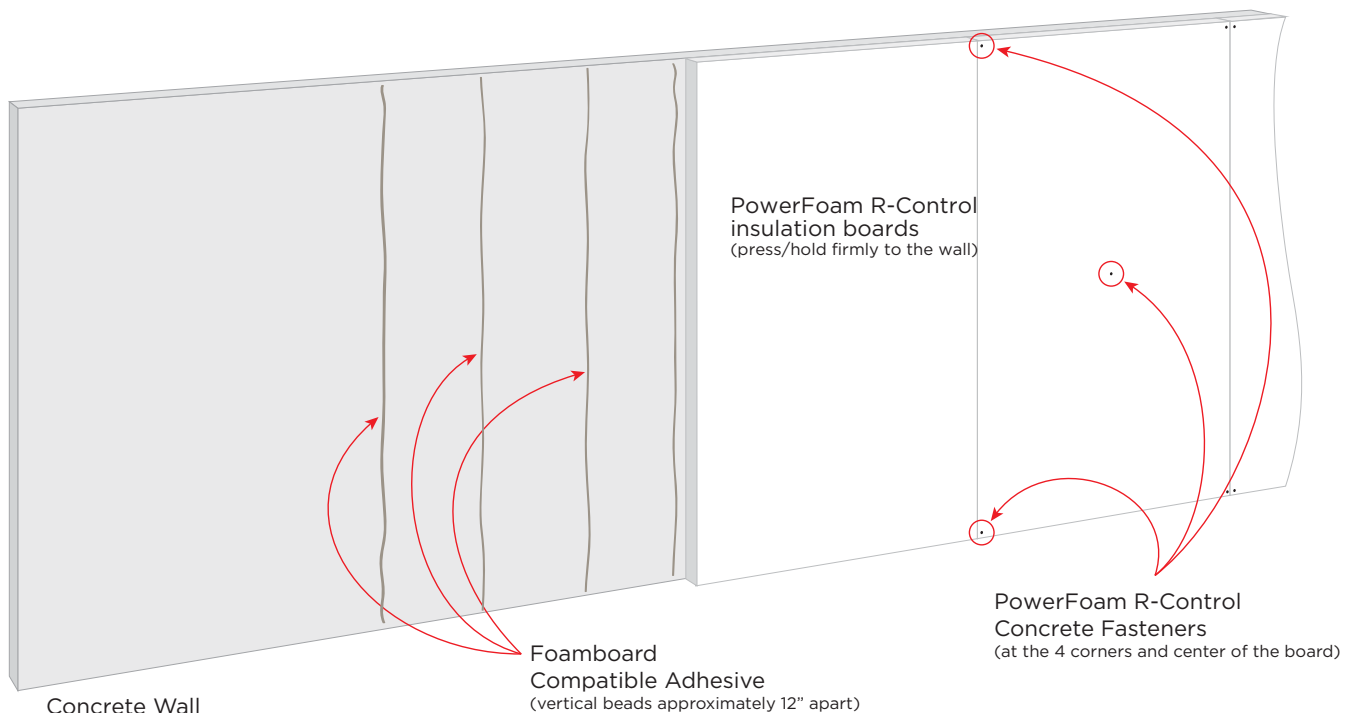

**Notice:** PowerFoam R-Control insulation contains a flame retardant; however, it should be considered combustible and should not be exposed to sources of ignition. The product will ignite when exposed to open flame or welding torches.